



# HuddleCamHD

152 Robbins Rd, Downingtown, PA, 19335, USA - [HuddleCamHD.com](http://HuddleCamHD.com) | 1 800 - 486-5276

## All New HuddleCam-HD 30X -Introducing USB 3.0 Video Conferencing- 30X Optical Zoom – 1920x1080 – 30 FPS More info @ [HuddleCamHD.com](http://HuddleCamHD.com)

Providing USB Video Conferencing Solutions for  
the 21<sup>st</sup> Century



# HuddleCamHD

USB 3.0 HD Camera



152 Robbins Rd, Downingtown, PA, 19335, USA - HuddleCamHD.com | 1 800 - 486-5276

## Precautions.....

### Safety Tips.....

- Please read this manual carefully before using the camera.
- Avoid damage from stress, violent vibration or liquid intrusion during transportation, storage or installation.
- Take care of the camera during installation to prevent damage to the camera case, ports, lens or PTZ mechanism.
- Do not apply excessive voltage. (Use only the specified voltage.) Otherwise, you may experience electrical shock.
- Keep the camera away from strong electromagnetic sources.
- Do not aim the camera at bright light sources (e.g. bright lights, the sun, etc.) for extended periods of time.
- Do not clean the camera with any active chemicals or corrosive detergents.
- Do not disassemble the camera or any of the camera's components. If problems arise, please contact your authorized dealer.
- After long term operation, moving components can wear down. Contact your authorized dealer for repair.

### Supplied Accessories.....

- HD Color Video Camera (1)
- 12V/2.0A DC Power Adapter (1)
- Installation Bracket (1)
- Installation Screw (1)



152 Robbins Rd, Downingtown, PA, 19335, USA - HuddleCamHD.com | 1 800 - 486-5276

- USB 3.0 Data Lines (3m), Serial Control Line, RS-232C to RS-485 Cable
- IR Remote Controller (1)
- User Manual (1)

## Rear Board Connectors.....

High Definition Interface:	USB 3.0
Control Signal Interface:	Mini DIN-8 (VISCA IN, VISCA OUT/RS485)
Control Signal Configuration:	Dip-Switch Pin 7/TTL Signal; Baud Rate: 9600bps
Power Supply Interface:	DC 12V Socket

## Electrical.....

Power Supply Adapter:	12V DC/2A
Input Voltage:	12V DC (10.5-14V DC)
Input Power:	24W (MAX)

## Structure.....

Material:	Aluminum, Plastic
Dimensions (W x H x D):	9.84 in. (250mm) x 5.51 in. (140mm) x 6.06 in. (154mm)
Mass:	2.84 lbs. (1.29 kg.)
Working Environment:	Indoor
Operating Temperature:	32°F (0°C) to 113°F (45°C)
Storage Temperature:	-14°F (-26°C) to 140°F (60°C)
Color:	Silver Gray

## Rear Board & Function.....

### 1. Front View.....



- 1. Lens**  
20x Optical Zoom.
- 2. IR Receiver**  
To receive IR remote controller signal.
- 3. Power LED**  
Blue LED blinks when unit is powered.
- 4. Stand by LED**  
Orange LED blinks for Stand-By status, Blue LED for Working Status.
- 5. IR Receiver**  
To receive IR remote controller signal.

## 2. Rear View.....



### 6. Power Switch

Power On/Off button.

### 7. DC IN 12V Socket

Only use the Power Adapter supplied with this camera.

### 8. IR Receiver

To receive IR remote controller signals.

### 9. IR Selective Switch

When using only one remote to control more than one camera, this switch will assign a unique ID to each camera.

### 10. VISCA IN Port

For hard wired remote control from a 3<sup>rd</sup> party PC, joystick, etc...

### 11. VISCA Out Port/RS485

Used for daisy chaining multiple cameras for RS-232 RS-485 control.

## 12. USB 3.0 Interface

For connection to PC USB 3.0 port (also compatible with USB 2.0 port and driver).

## 2. Bottom View.....

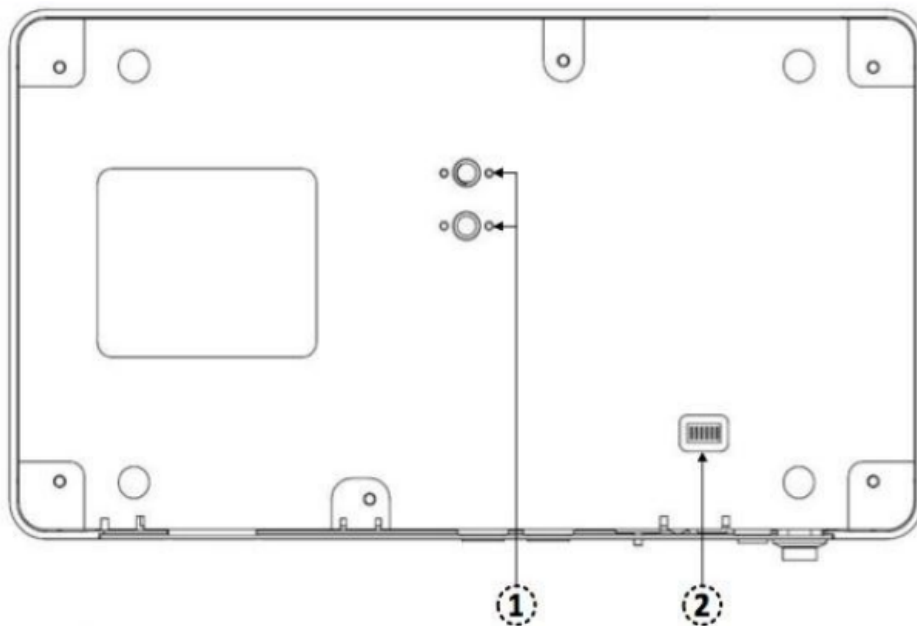

### 1. Tripod

Will accept 1/4-20 bolt from 3<sup>rd</sup> party tripod, wall or ceiling mount.

### 2. Dip-Switch

Used for selecting baud rate and the remote signal output switch.

## 4. Dip-Switch Settings.....

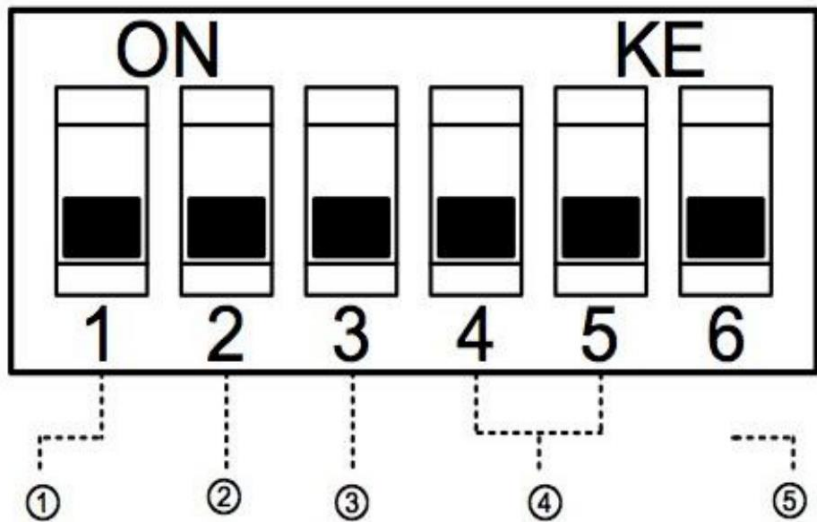

**Note:** When changing Dip-Switch settings, make all changes with camera powered off.

**Dip-Switch 1** - (To set communication baud rate).

**Dip-Switch 2** - (To set control protocol).

**Dip-Switch 3** - (Set only for firmware upgrading).

**Dip Switch 4 & 5** - (To set camera's RS232/RS485 ID number - for daisy chain wired control).

### Camera address code setting

	Dip-switch4	Dip-switch 5
1	OFF	OFF
1	OFF	ON
2	ON	OFF
3	ON	ON

[Cable Connection Info.....](#)

[VISCA RS-232C - IN Reference.....](#)

VISCA RS-232C IN

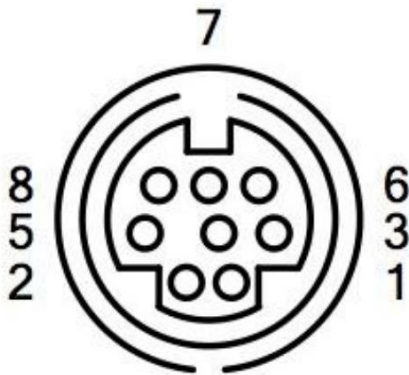

Pin S/N	Function
1	DTR IN
2	DSR IN
3	TXD IN
4	GND
5	RXD IN
6	GND
7	IR Commander Signal OUTPUT
8	NO Connection

[VISCA RS-232C - Out Reference.....](#)

VISCA RS-232C OUT

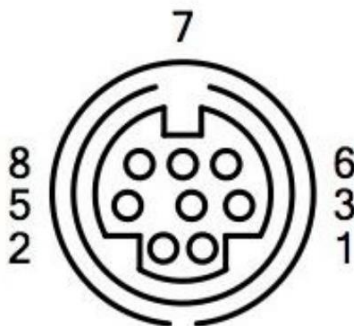

Pin S/N	Function	
	RS-232	RS-485
1	DTR OUT	TX+
2	DSR OUT	TX-
3	TXD OUT	
4	GND	
5	RXD OUT	
6	GND	
7		RS-485 -
8		RS-485 +





152 Robbins Rd, Downingtown, PA, 19335, USA - [HuddleCamHD.com](http://HuddleCamHD.com) | 1 800 - 486-5276

## OSD MENU.....

**On Screen Display Menu** - Use the OSD menu to access and change the camera's settings.

**Note:** You cannot manually move the camera (pan/tilt) when the OSD menu is visible on the screen.

### The Dome OSD Menu is as follows:

- Pan Speed** **Default Value: 20**  
Set speed of Pan motor - Range = 1 - 63
- Tilt Speed** **Default Value: 20**  
Set speed of Pan motor - Range = 1 - 63
- Scan Speed (Auto Pan Mode)** **Default Value: 6**  
Set speed of boundary scan - Range = 1 - 63
- Tour Path (uses presets)** **Default Value: 1**  
Select desired tour path - Range = 1 - 4
- Tour Dwell** **Default Value: 5**  
Set duration to dwell on each preset - Range = 1 - 60
- Proportion** **Default Value: On**  
Set Proportion - Range = On - Off
- Auto Rev** **Default Value: P**  
Set camera mounting orientation - N for inverted ceiling mount
- Frame** **Default Value: 60Hz**  
Set Refresh Rate - Range = 50Hz or 60 Hz



152 Robbins Rd, Downingtown, PA, 19335, USA - [HuddleCamHD.com](http://HuddleCamHD.com) | 1 800 - 486-5276

The Lens OSD Menu is as follows:

- WDR**  
Wide Dynamic Range = On or Off  
Default Value: Off
- BACKLIGHT**  
ON/OFF  
Default Value: OFF
- NR (Noise Reduction)**  
Adjustable Value: 0-5  
Default Value: 3
- WB (White Balance)**  
Auto/Manual/Outdoor/Indoor/One Push/ATW  
(Manual Settings):  
Default Value: Auto
  - R GAIN (Red Gain)**  
Adjustable Scope: 0-255  
Default Value: 64
  - B GAIN (Blue Gain)**  
Adjustable Scope: 0-255  
Default Value: 84
- AE (Auto Exposure)**  
Auto/Manual  
(Manual Settings):  
Default Value: Auto
  - SHUTTER**  
Shutter Speed Range: 1/1-1/10000  
Default Value: 1/1
  - IRIS**  
Close/F1.4-f22  
Default Value: Close
  - BRIGHT**  
Set Brightness 0 - 31  
Default Value: 0



## IR Remote Controller (Note: Some buttons do not operate for all camera models)

1. **Reset:**  
Restarts the camera and restores it to Factory Default settings.  
(Note: Will delete all memory).
2. **Camera Selection**  
Select Camera ID: 1, 2 or 3
3. **Preset Positions**  
1-9: Preset Positions  
Set: Setting Preset Position  
Clear: Clear Preset Position  
Call: Call Preset Position  
**Note:** If you want to set (or call) the first preset position to 1, you should press number key "1", then press "Set" (or "Call") to set (call) the position.
4. **Fast Zoom in/out Control Zone**  
+: Zoom in quickly  
-: Zoom out quickly
5. **Pan/Tilt Controller**
  - ↑ Move Up
  - ↓ Move Down
  - ← Move Left
  - Move Right
  - ↺ Auto Pan
6. **Additional Function Zone**  
Freeze: Image Freeze  
BL: Back-light Compensation  
WB: White Balance  
AE: Auto Exposure  
D Zoom: Digital Zoom  
HDMI: Swap to HDMI video output  
DVI: Swap to DVI video output  
Format: Swap between different formats
7. **Power Supply Switch**  
Switch for turning camera on (i.e. Stand-By mode vs. Working mode)
8. **OSD Menu Zone**  
Dome OSD: Enter Pan Tilt Zoom OSD menu  
Lens OSD: Enter lens OSD menu
9. **Slow Zoom In/Out Zone**  
+: Zoom in slowly  
-: Zoom out slowly
10. **Focus Control Zone**  
Auto: Turn on auto focus  
Manual: Turn on manual focus  
Far: Set focus at farther distance  
Near: Set focus at nearer distance

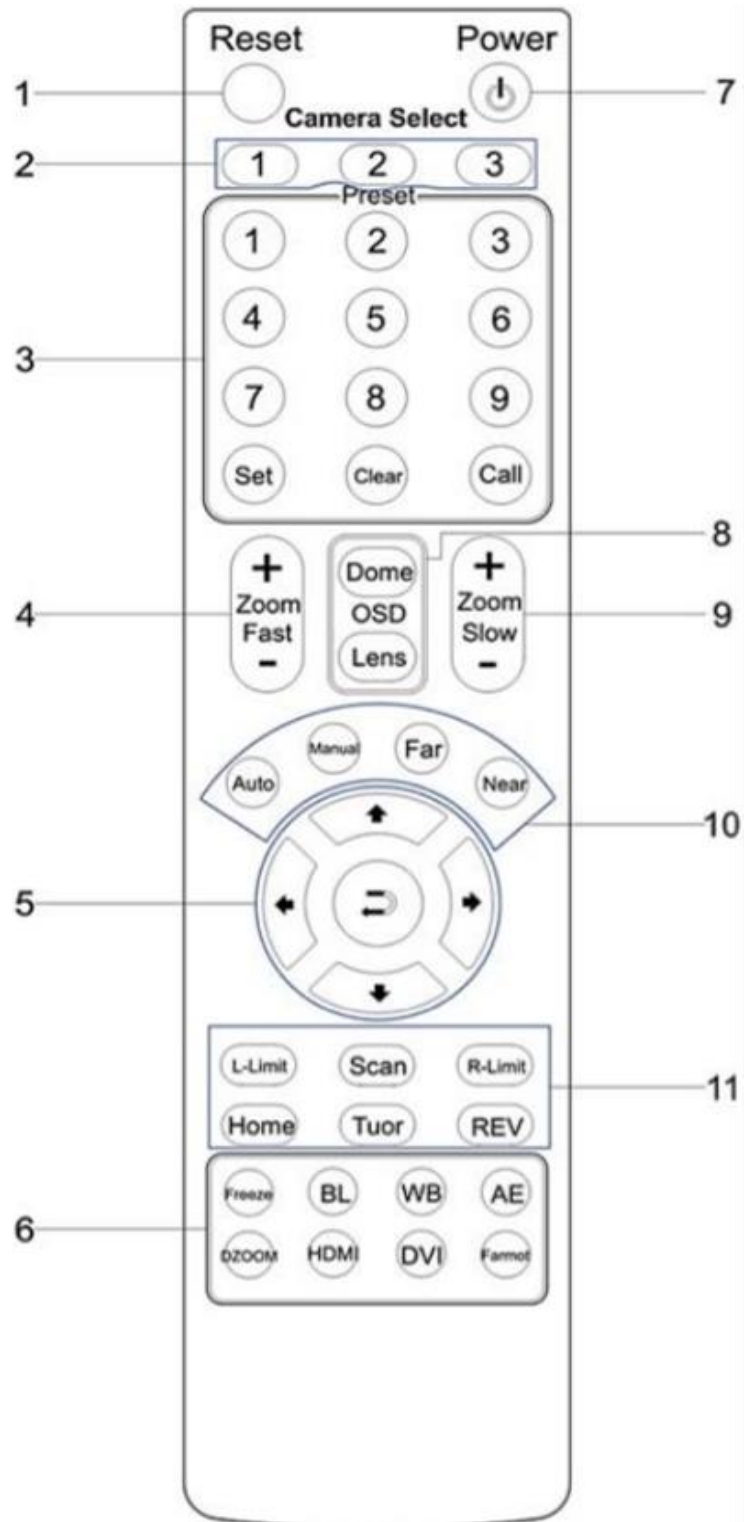



152 Robbins Rd, Downingtown, PA, 19335, USA - [HuddleCamHD.com](http://HuddleCamHD.com) | 1 800 - 486-5276

- 11. **Pan/Tilt Function Zone**
  - L-Limit: Set left boundary limit scanning position
  - Scan: Enable Boundary Scanning (Auto Panning)
  - R-Limit: Set right boundary limit scanning position
  - Home: Go to camera's Home position
  - Tour: Enable automatic patrol tour of presets
  - Rev: Enable image flip for ceiling mounting

## Connection Instructions.....

1. Connect included Power Supply to the camera.
2. Wait for camera to come to Home Position.
3. Connect included USB 3.0 cable to camera and USB 3.0 port of PC (unit is also backwards compatible with USB 2.0 port).
4. Select and configure camera in your software of choice.

**NOTE:** Failure to follow this sequence may result in no connection to PC.

## Care Of The Unit.....

Remove dust or dirt on the surface of the lens with a blower (commercially available).

## Installation Instructions.....

### Desktop Installation.....

When using the HuddleCam™ on a desk, Make sure that it will stand level. If you want to use the camera on an incline, make sure the angle is less than 15 degrees to ensure that the camera's pan and tilt mechanism operates normally.

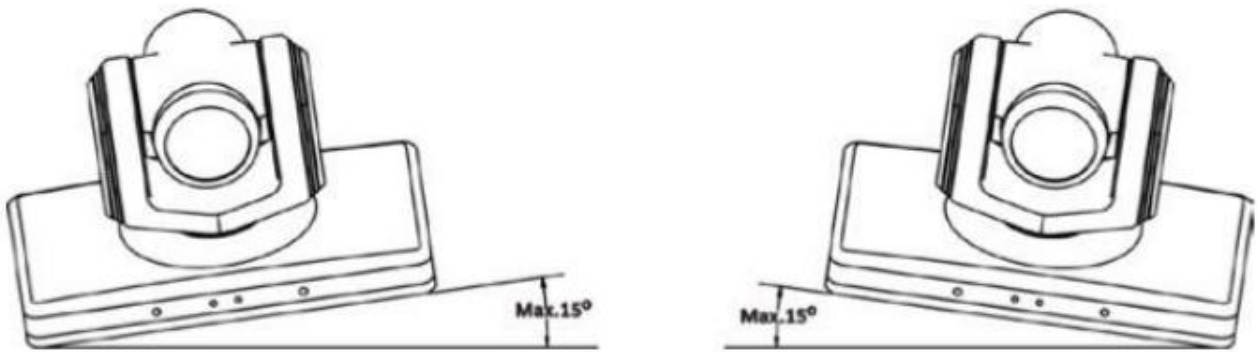

### Tripod Installation.....

When using the HuddleCam™ with a tripod, screw the tripod to the bottom of the camera. The tripod screw must fit below specifications:

**Note:** Tripod must stand on a level surface.

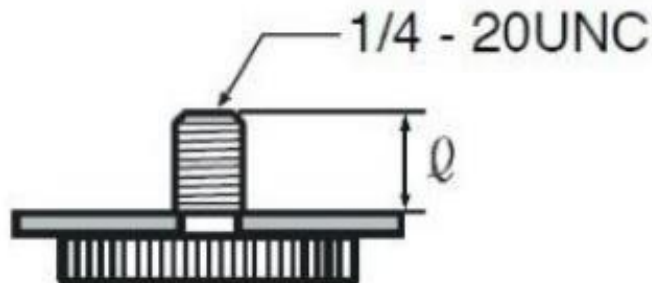

$$\phi = 5 - 7 \text{ mm}$$



# HuddleCamHD

152 Robbins Rd, Downingtown, PA, 19335, USA - [HuddleCamHD.com](http://HuddleCamHD.com) | 1 800 - 486-5276

## Ceiling Mount.....

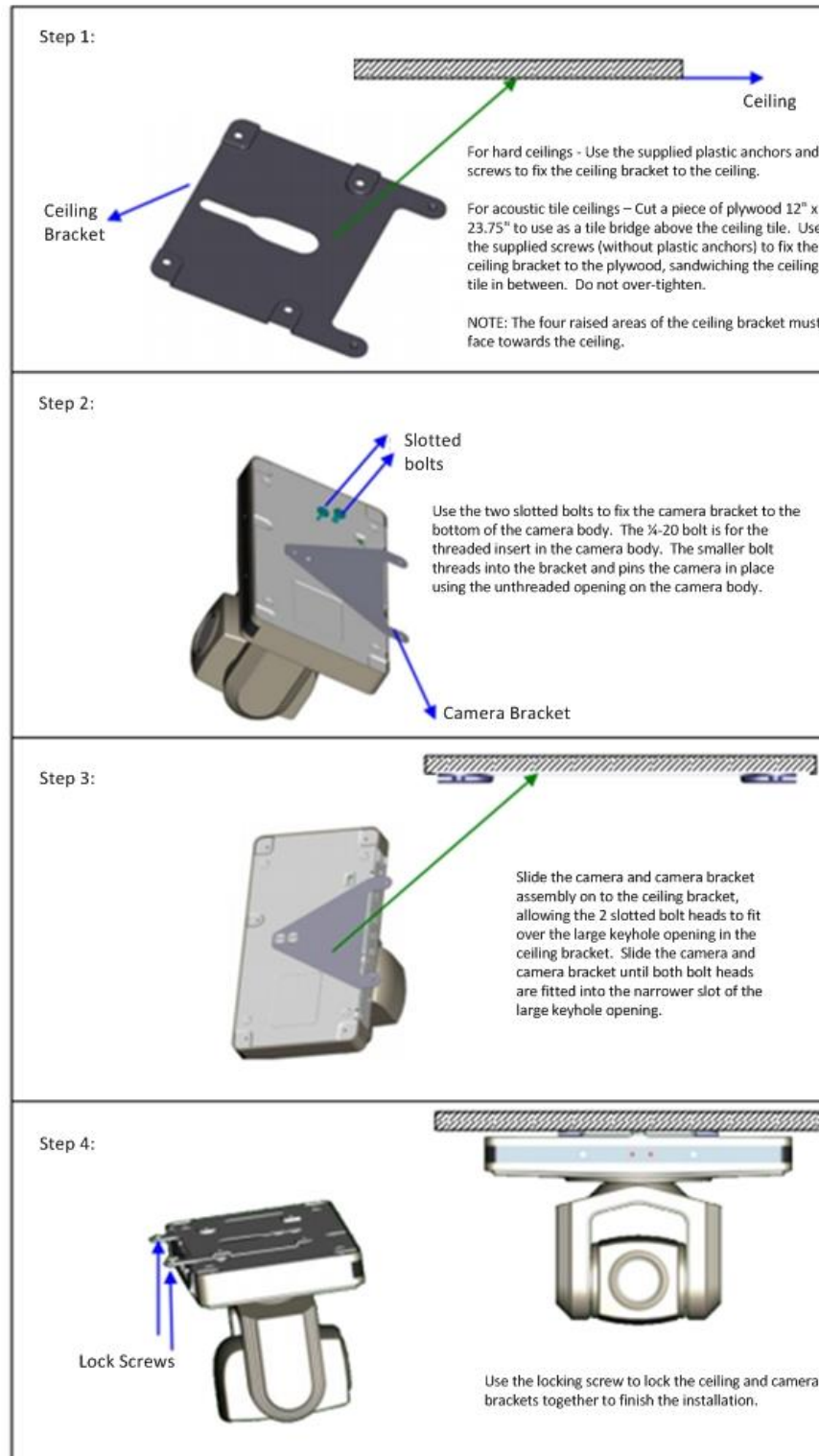



152 Robbins Rd, Downingtown, PA, 19335, USA - [HuddleCamHD.com](http://HuddleCamHD.com) | 1 800 - 486-5276

[Troubleshooting.....](#)

Problem	Cause	Resolution
There is no power to the camera.	Power adapter is disconnected from mains or from camera.	Check the connections between the camera, power adapter and mains. If anything is disconnected, reconnect it.
	Power switch is set to OFF.	Set the power switch to ON.
Camera will not connect to the PC via USB.	USB cable is bad.	Try new USB Cable
	Camera connects sometimes.	Connect USB only after camera has completely booted.
Camera unable to pan, tilt, and/or zoom.	Menu is currently displayed on the screen.	Retry after exiting the menu.
	Pan, tilt or zoom range limit was reached.	Try to pan/tilt/zoom in the other direction.
Remote control not working.	The “camera select” button on the remote control is not set to match the “IR select” switch number set on the camera.	Choose the correct “IR select” number to match camera settings.
Camera cannot be controlled via VISCA.	The connection between the PC and camera is incorrect.	Refer to Cable Connection Info section of this manual.
	Commands being sent are incorrect.	Refer to VISCA manual.
The Camera is not working at all.	No response or image from camera.	Disconnect power, and wait a few minutes, then connect the power again. Retry.



# HuddleCamHD

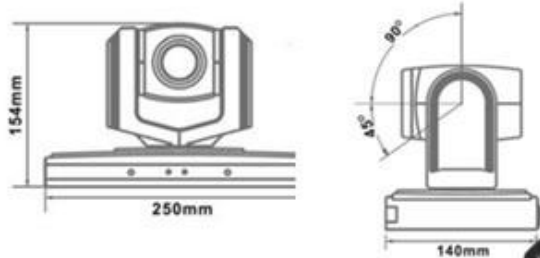

## • Technical Specifications

- 1920x1080p 30fps | 1280x720p 30fps
- 20X Optical Zoom
- 1/2.8 Exmor CMOS Sensor
- Field of View 55.4°
- Focal Length: f=4.7-90mm;
- 3.27 Megapixels
- Pan 0°- 355°
- Tilt -45°- +90°
- 9 Presets
- Min Lux 0.1
- VISCA Control / Baud Rate 9600/38400bps
- Supports image flip



USB 3.0 provides high quality 1920x1080 pixels progressive @ 30fps